

## ALUMINUM FRAMES

*This popular frame system has proven itself in the marketplace for the past 10 years as a good-looking, flexible, and cost-effective system.*

*Ideal for interior signage use:*

- ADA Room Signs
- Directories
- Displays
- Menu Boards
- Directional Signs

*Standard colors:  
black or silver*



To  
order call  
612-377-9156



### Aluminum Frames

The Aluminum Frame System incorporates many of the features of our popular High-Impact Styrene Frames and adds an exciting choice of metal finishes and custom sizing all at an affordable price. The frames are lightweight, durable, and provide a clean finished look to the sign with no raw edges or mounting methods visible. The sign inserts fit securely into the frames for tamper-resistant signage.

Aluminum frames have a satin anodized finish and are available in black or silver. Custom colors and finishes are available.

#### Features:

- Custom sizing
- Lightweight and durable
- Frames can accept a variety of substrates; aluminum, plastics
- Sign inserts are easily changeable and can be modular
- Concealed mounting
- Easy installation with either screws, tape, or velcro
- Easy sign removal for building maintenance such as painting walls.

#### Two Edge Styles:

##### 100 Series

Features a thin edge with the sign insert recessed into the frame.

##### 200 Series

Features a 3/16 inch radius edge design that matches our High-Impact Styrene Frames and a front reveal that allows the sign insert to have a slightly recessed appearance.

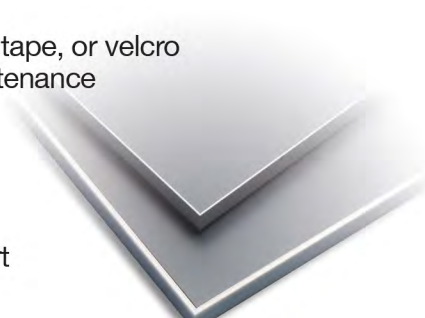

## Aluminum Frames

Aluminum frames incorporate “picture frame technology” for incredible flexibility with unlimited sizing. Pre-cut lengths are stocked in many sizes for quick assembly. Custom sizes are available at no extra charge.

### NEW FRAME DESIGN

Two edge styles are available:

#### 100 Series

Features a thin 1/16 inch edge. The sign insert fits recessed into the frame using our exclusive snap lock mechanism.

#### 200 Series

Features a 3/16 inch radius edge design that matches our High-Impact Styrene Frames and a front reveal that allows the sign insert to have a slightly recessed appearance. The sign face fits into the frame using our exclusive snap lock mechanism.

### SUPPORT BRACKETS

Support brackets are available for use with larger signs and when modular sign inserts are used. Support brackets are available in all frame sizes.

### COLORS

Available in black or silver with a satin anodized finish. Custom colors and finishes are available and subject to minimum order requirements.

### SNAP LOCK MECHANISM

Each snap lock has a pressure sensitive adhesive tab to hold the sign face securely in place within the frame and provide tamper-resistant signage. Snap locks allow for easy sign face insertion, removal, and replacement.

### MOUNTING

Frame back is designed for tape concealment. Mounting holes can be added to accommodate standard hardware for various types of installations.

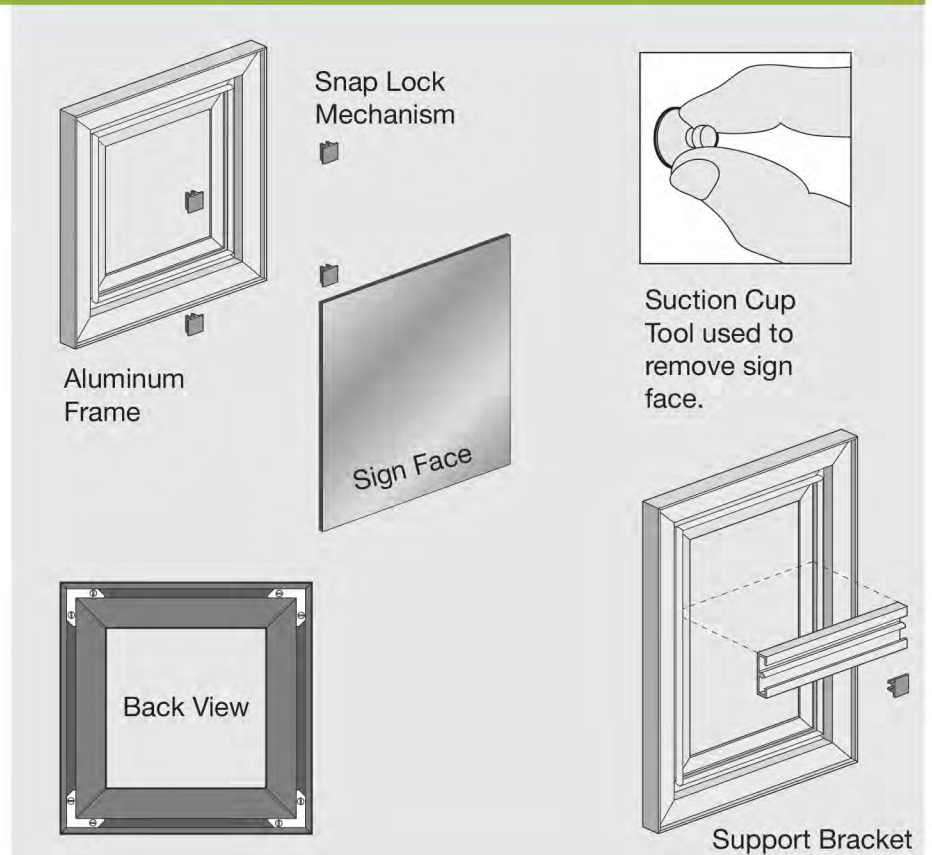

### ALUMINUM FRAME PARTS ARE STOCKED IN THE FOLLOWING SIZES

SIZE	QTY. Per Pkg.	FRAME STYLE	COLOR	
			Black	Silver
3 inch (76mm)	1 pair	100 or 200	✓	✓
4 inch (101mm)	1 pair	100 or 200	✓	✓
5 inch (127mm)	1 pair	100 or 200	✓	✓
6 inch (152mm)	1 pair	100 or 200	✓	✓
7 inch (177mm)	1 pair	100 or 200	✓	✓
8 inch (203mm)	1 pair	100 or 200	✓	✓
9 inch (228mm)	1 pair	100 or 200	✓	✓
10 inch (254mm)	1 pair	100 or 200	✓	✓
11 inch (279mm)	1 pair	100 or 200	✓	✓
12 inch (304mm)	1 pair	100 or 200	✓	✓
15 inch (381mm)	1 pair	100 or 200	✓	✓
18 inch (457mm)	1 pair	100 or 200	✓	✓
20 inch (508mm)	1 pair	100 or 200	✓	✓
24 inch (609mm)	1 pair	100 or 200	✓	✓
36 inch (914mm)	1 pair	100 or 200	✓	✓
48 inch (1219mm)	1 pair	100 or 200	✓	✓
8 foot length (2438mm)	1	100 or 200	✓	✓

When fabricating sign faces, allow .005 - .010" (0.127 - 0.254 mm) clearance for expansion and contraction of materials.